

Planned Setup for Aerosol Instrumentation at Stasiun Pemantau Atmosfer Global Kototabang, Indonesia

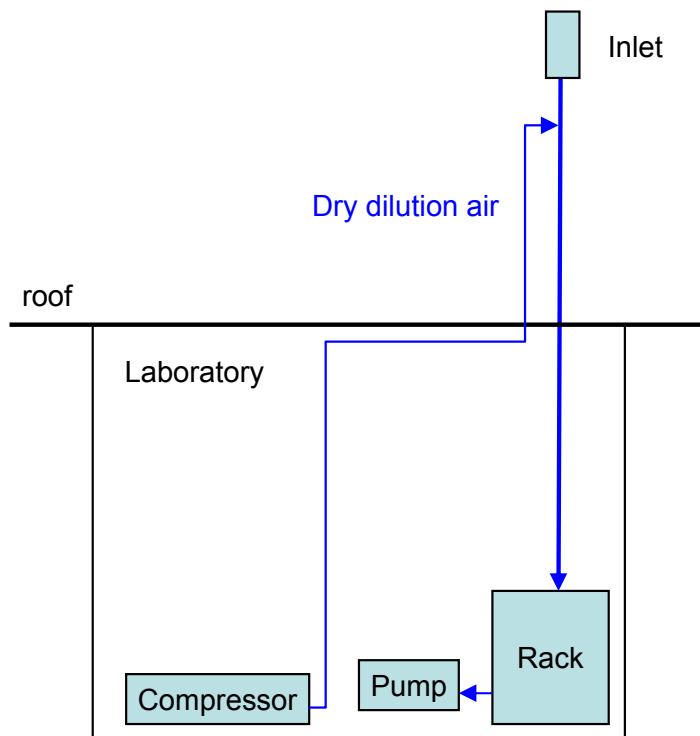

Flow System and Hardware

Main Features:

- TSP sampling head on the roof
- Dilution with dry air (necessary)
- Compressor for dilution air
- Straight sampling line across the roof
- Instrument rack inside the lab
- One pump for all instruments (outside the rack)
- UPS protection

Data Aquisition

Main Features:

- Freeware based system, no licences
- Operating system: Linux based LiveCD
- Data aquisition: CPD2 (NOAA/Boulder)
- Data storage on memory stick
- Automatic data transfer to selected FTP servers

Basic sketch of instrument rack and inlet

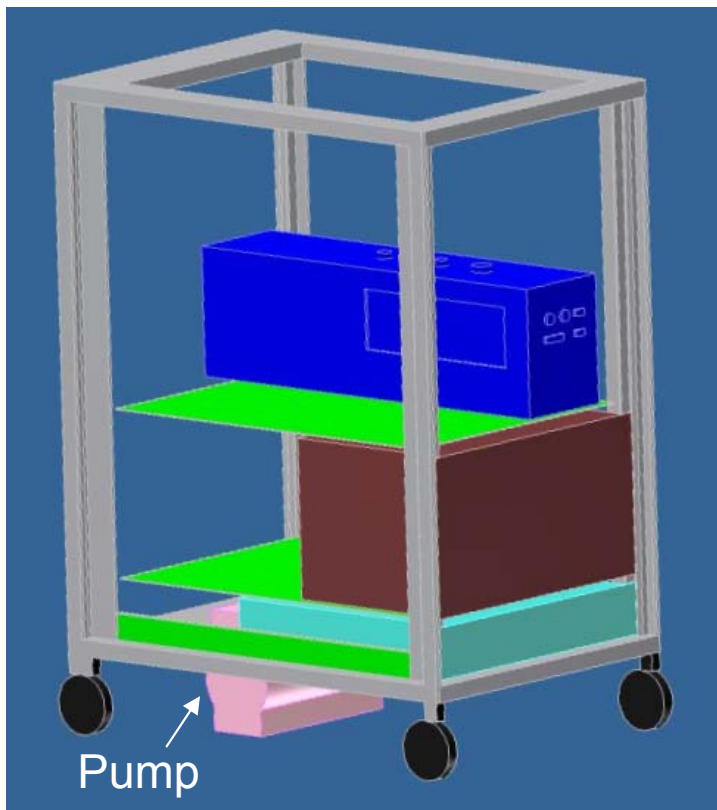

Nephelometer

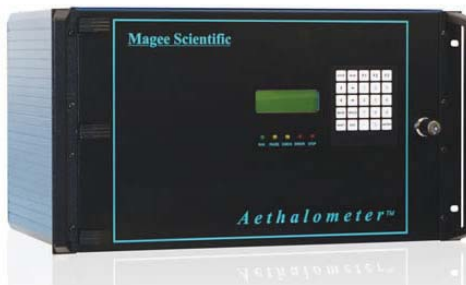

Aethalometer

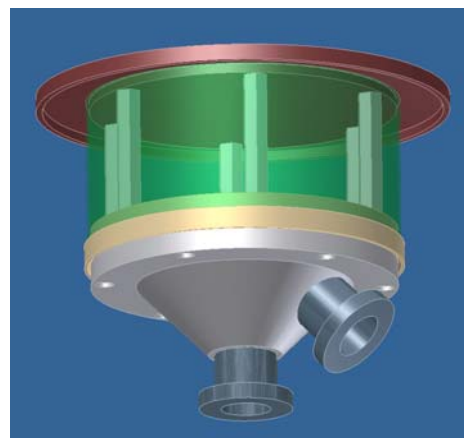

Inlet

Rack (19 Inch) dimensions:
Width: 553 mm
Height: 1200 mm
Depth: 800 mm

Compressor dimensions: W 1000 mm, H 1000 mm, D 500 mm, weight 73 kg

Flow System and Hardware

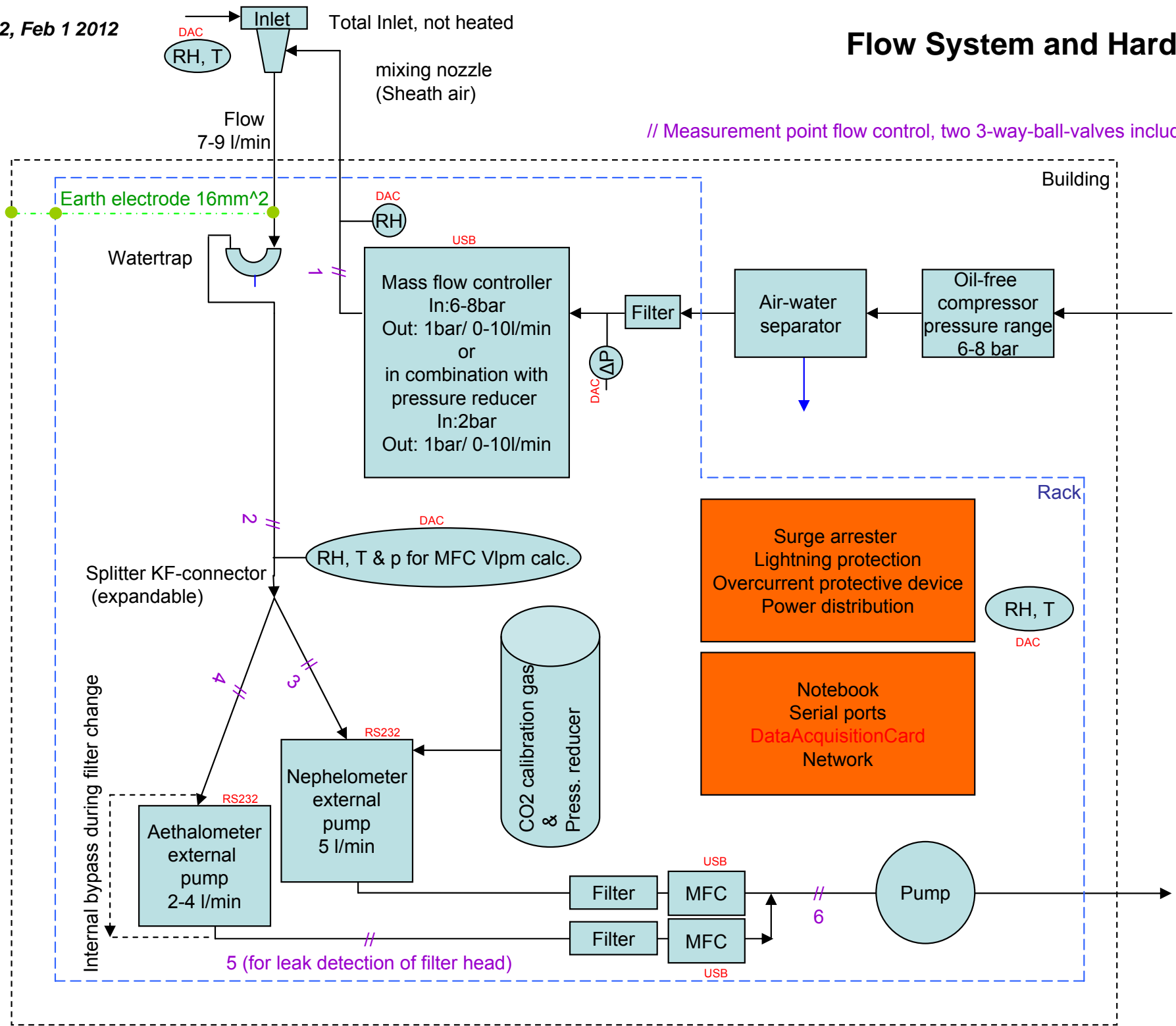

Data Acquisition System

